

# PP-9715W and PP-9715 a XPPC family's high performance Panel PC



May 31<sup>th</sup> 2021



# FEC

---



# XPPC Family & schedule

PP-9125W

PP-9715W

PP-9715



# Features

---



- **Slim:** With high efficiency thermal module
- **High performance:** Using Intel Coffee Lake 8<sup>th</sup> or 9<sup>th</sup> Generation Processor & Support High speed PCIE M.2 SSD
- **Panel PC with Dual hinge stand:** Adjustable angle and height improve the viewing angle, enhance the user experience, can also be Desktop, Pole or Wall-mounted.
- **Easy for maintenance:** Easy to access DRAM/ SSD/ MB
- **Shared Peripherals:** Share the same peripherals with XPOS
- **Pole Type 2<sup>nd</sup> screen:** Angle can be adjusted
- **Support FEC Platform**

# Structure – Front view

---



15" or 15.6" High performance Panel PC  
With 8<sup>th</sup> or 9<sup>th</sup> Celeron / Pentium / i3 / i5 and  
P-cap touch screen

Extend IO (optional)  
If without IO, adapter could be fitted in the stand

# Structure – Back view

---



# FEC PERFORMANCE IS TWICE AS FAST AS PP-9645

---

	Intel Celeron G1820TE @2.20GHz (PP9645)	Intel Celeron G4900T @2.90GHz New XPPC (PP-9715W)
Socket Type	LGA1150	FCLGA1151-2
CPU Class	Desktop	Desktop
Clockspeed	2.2GHz	2.9GHz
Turbo speed	Not Supported	Not Supported
# of physical Cores	2 (Threads: 2)	2 (Threads: 2)
Max TDP	35W	35W
# of examples	6	8
Single Thread Rating	733	1809
CPU Mark	<b>1129</b>	<b>2311</b>



# Flexible Dual hinge stand

---



Angle and height of dual hinge stand are adjustable, which can improve viewing angle, improve user experience, and save the shipping cost.



# Easy access to MB

---



How to access MB  
1. Flip cable cover  
2. Remove 3 screws



screw



# Cable management

---

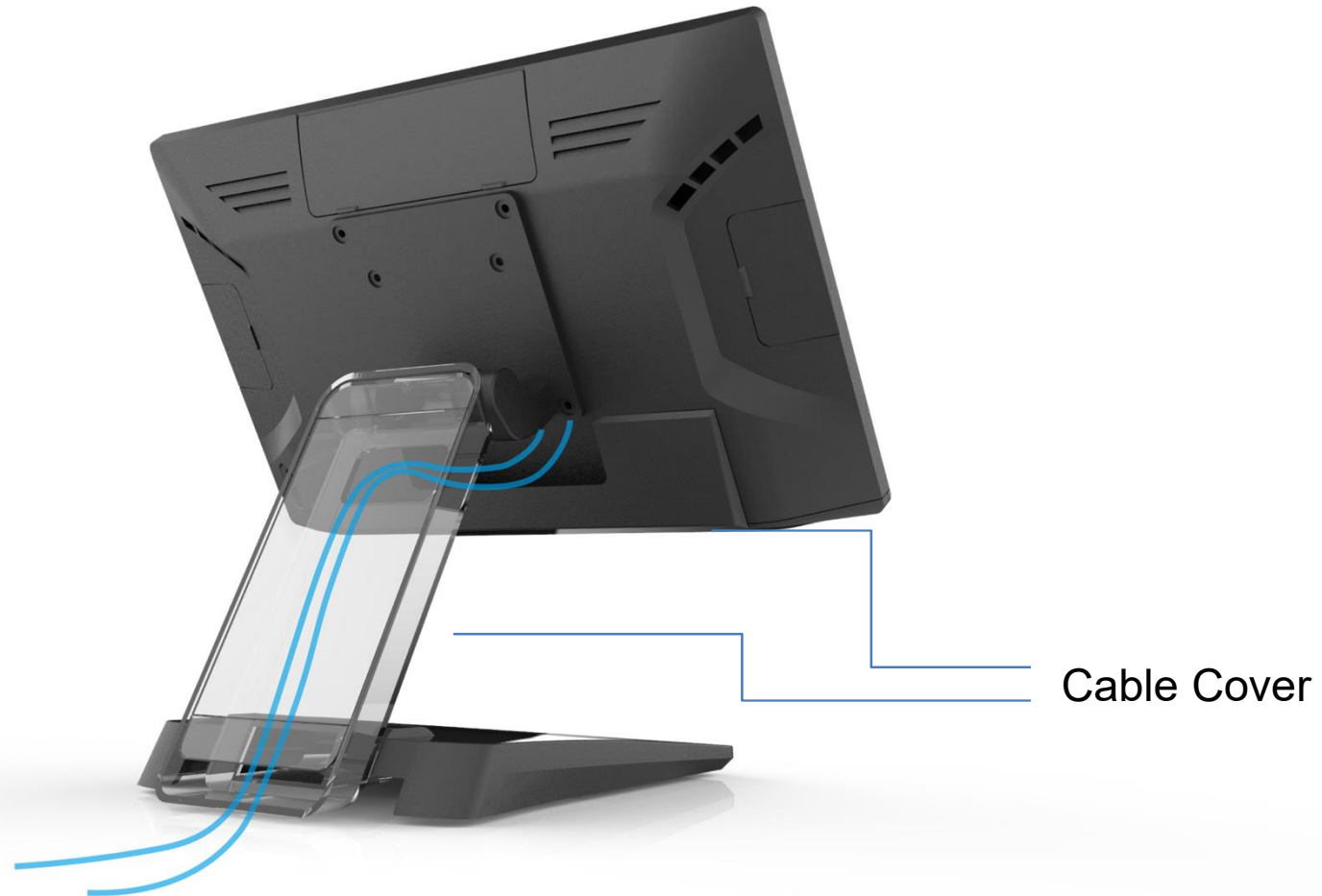

# Shared Peripherals with XPOS

---

Integrated type 2<sup>nd</sup> Display: XP-2025 / XM-1010W

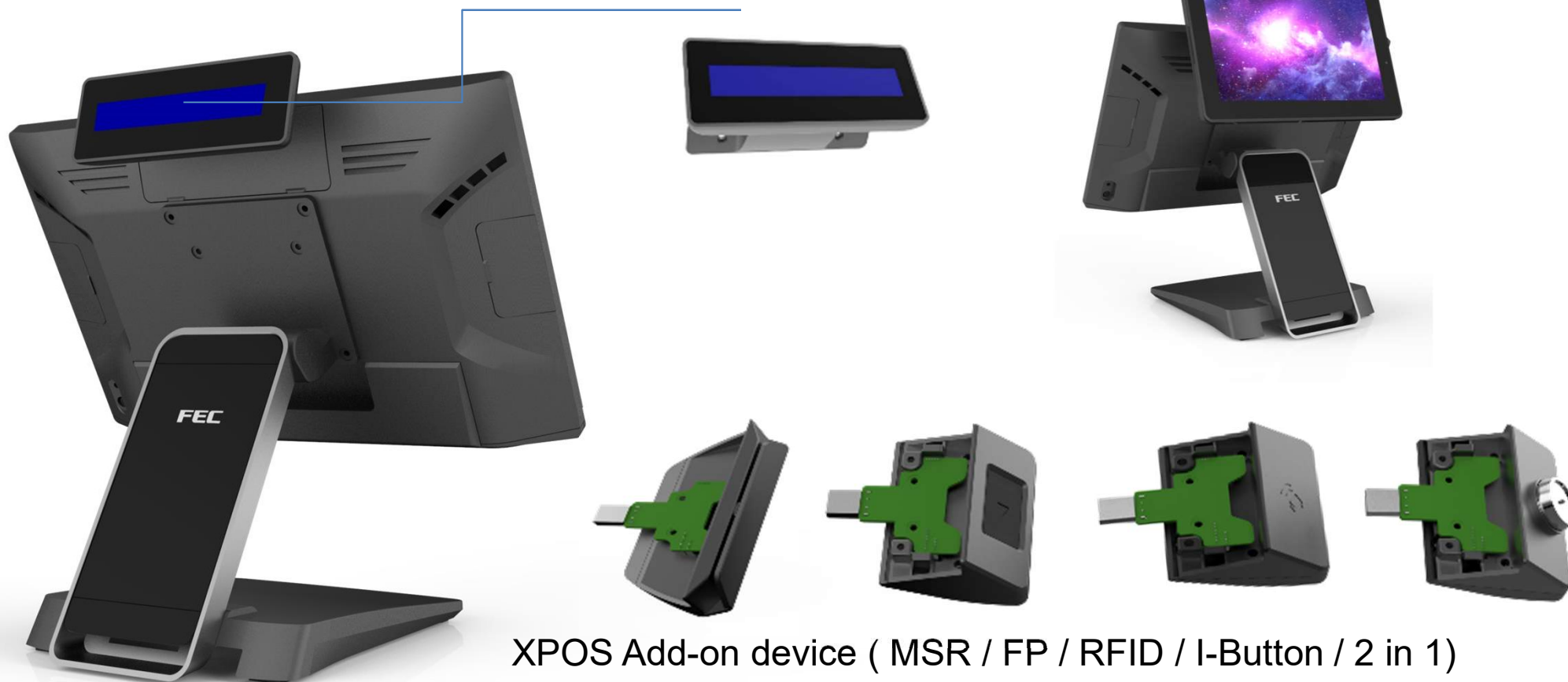

## 2<sup>nd</sup> Monitors (Arm type)

---

Arm Type 2<sup>nd</sup> monitor : XM-1010W



## 2<sup>nd</sup> Monitors (Arm type)

---

Arm Type 2<sup>nd</sup> monitor : XM-1015 / XM-1015W



## 2<sup>nd</sup> Monitors (Arm type)

---



# Pole Type 2<sup>nd</sup> Display

---

Pole Type Customer display : XM-3015 / XM-3015W  
(Pole type Display Height can't adjust)





# Wall-mount Kit

---

Wall-Mount BKT (VESA 100 x 100 )

Or 3<sup>rd</sup> party pole support

Type I

FEC Universal  
Mounting Kit  
(VESA 100 x 100)



Type II

FEC Universal  
Mounting Kit  
(VESA 100 x 100)

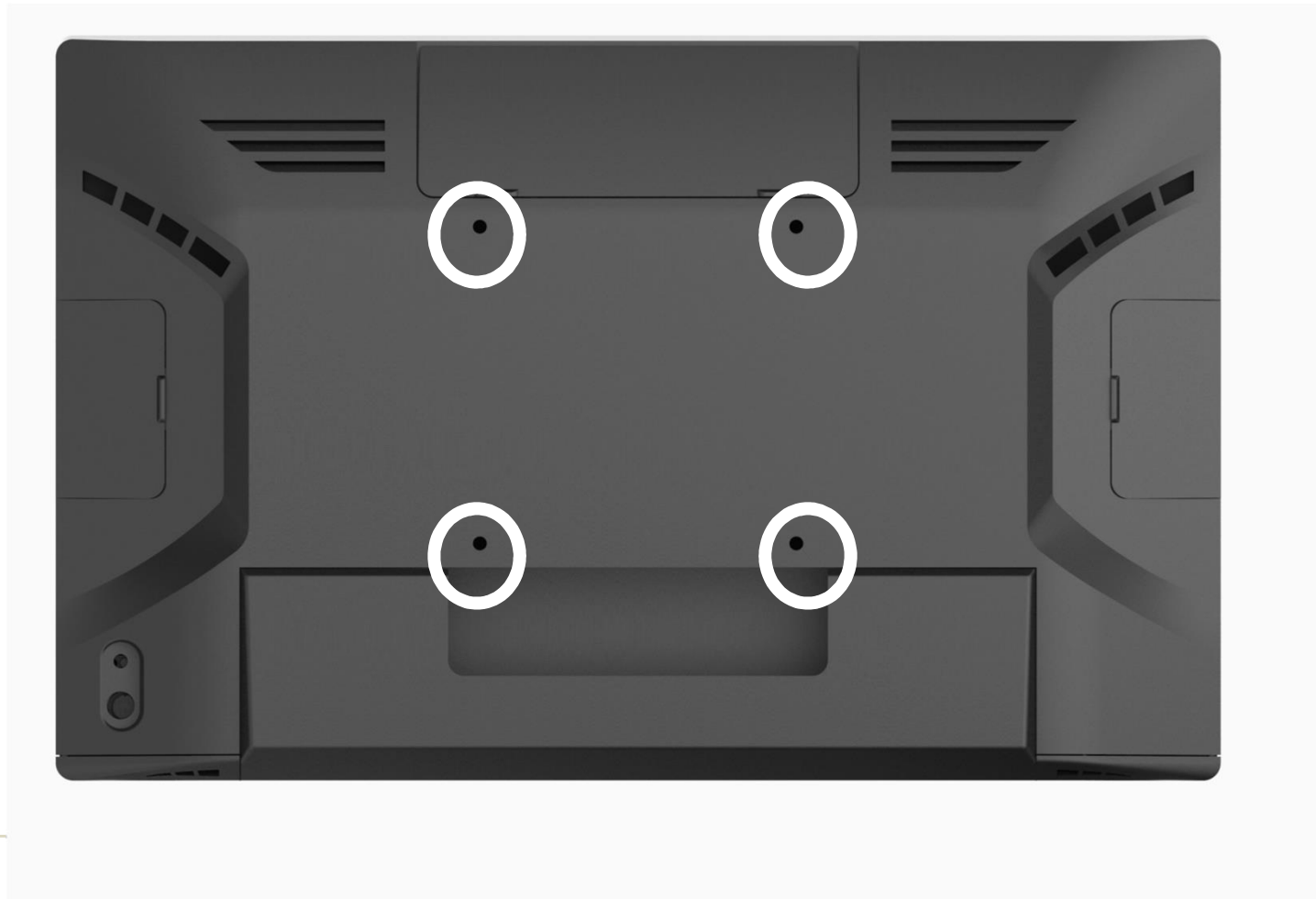

# Adapters

---

If without 2<sup>nd</sup> I/O, adapter could be fitted in the stand.



130W Power Adapter

# Color Plan & Logo

---



# FEC

---



Single hinge & Dual hinge -Galaxy Gray / Silver

# 15.6" XPPC Dimension

---



W\* D\* H = 368\* 257 \*315 mm

# FEC Platform feature



01. Remote Management and Control

02 .Automated Alarm Notification

03 .Peripheral Firmware Update

04 . Device Heartbeat Monitoring

05 . Software/Application Distribution

06 . I/O Port Configuration and Deployment

07 . Device M/B BIOS updates



# Specification

	PP-9715W (launch by May.-2021)	PP-9715 (launch by July of 2021)
Processor (35W)	CELERON - G4900T (Embedded )(8 Gen) PENTIUM-G5400T (Embedded)(8 Gen) I3-9100TE (Embedded)(9 Gen) I5-9500TE (Embedded)(9 Gen)	CELERON - G4900T (Embedded )(8 Gen) PENTIUM-G5400T (Embedded)(8 Gen) I3-9100TE (Embedded)(9 Gen) I5-9500TE (Embedded)(9 Gen)
MB Technology	H310 Q370 of PP-9725W is for project base	H310 Q370 of PP-9725 is for project base
Screen size	15.6"	15"
Aspect ration Resolution	16: 9 = 1920 x 1080	4:3 =1024 x 768
Touch	P-Cap	P-Cap
Brightness	300 nits / LED	400 nits / LED
Memory	DDR4 SO-Dimm Slot x 2 (Support 2666 MHz & max 64G)	DDR4 SO-Dimm Slot x 2 (Support 2666 MHz & max 64G)
Storage	M.2 2280 slot x 2 (Interface SATA 3 & Support PCIE)	M.2 2280 slot x 2 (Interface SATA 3 & Support PCIE)
Wifi / BT (Optional)	802.11 ac 2.4/5 GHz + BT (PH17Q5)	802.11 ac 2.4/5 GHz + BT (PH17Q5)
OS Support	Windows 10 CBB / Pro / LTSB / LTSC / Linux	Windows 10 CBB / Pro / LTSB / LTSC / Linux
Speaker	2W x 2	2W x 2
Power adapter	130W x 1	130W x 1

# I/O port

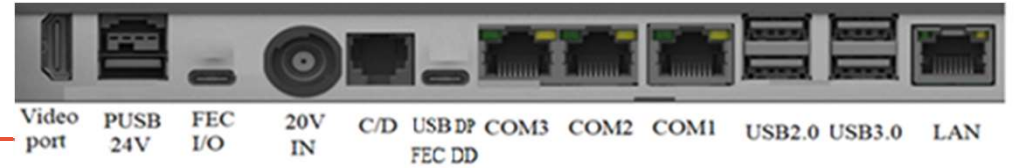





I/O port	Description	Application
Video Ports	HDMI x1	For 2 <sup>nd</sup> HDMI Monitor
PUSB 24V	24V Power USB	
FEC I/O	Including 5V/12V/24V (BIOS select) and USB 2.0 x 2 and Com port x 1	FEC I/O cables refer P.30
20V in	20V DC in ( 130W )	
Cash drawer	12V / 24V adjust by bios	
USB DP or FEC DD	USB TC x1 (USB DP, FEC DD by BIOS select )	For 2 <sup>nd</sup> USB DP Monitor refer P.14~P.17
Serial port	RJ45 Com port x <b>3</b>	
USB	USB 2.0 x <b>2</b> , USB 3.0 x <b>2</b>	
Ethernet	Giga Lan	





## FEC I/O Cables

	Cable Type	Application	Icon	Side A	Side B	
1	12V Y cable	2 <sup>nd</sup> Monitor		TC connector	12V DC jack & USB B	Project base
2	24V Printer Y cable	Printer		TC connector	3 pin hoshiden & USB B	Project base
3	COM cable	Com port device		TC connector	DB 9	optional
4	USB cable	Payment device power		TC connector	12V DC jack	Project base

## 2<sup>nd</sup> IO (Project base)

---



Reserved space to allow more I/O port  
by project base

## ON/OFF Switch for M.2

---



This switch is for each M.2 respectively and didn't support HOT SWAP

A background network diagram consisting of a complex web of thin grey lines connecting various circular nodes. Some nodes are solid grey, some are solid red, and some are semi-transparent grey. The overall aesthetic is clean and modern, suggesting a digital or business network.

# FEC

ELEVATE YOUR BUSINESS

## THANK YOU

© COPYRIGHT 2018 FIRICH ENTERPRISES CO., LTD. ALL RIGHTS RESERVED.